



FAG

2200-2RS-TVH

Self-aligning ball bearing

Schaeffler ID:
0167025900000Self-aligning ball bearing 22...-2RS-TVH,
seals, plastic cage

Technical information

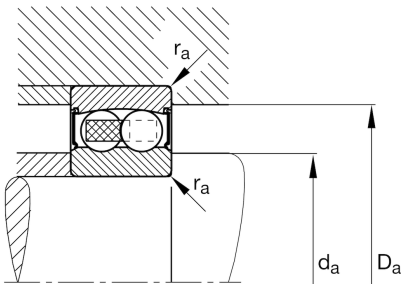
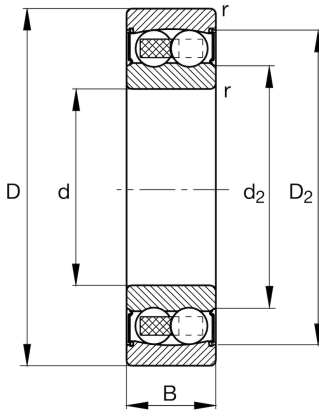
**Main Dimensions & Performance Data**

d	10 mm	Bore diameter
D	30 mm	Outside diameter
B	14 mm	Width
C_r	5.700 N	Basic dynamic load rating, radial
C_{0r}	1.190 N	Basic static load rating, radial
C_{ur}	76 N	Fatigue load limit, radial
n_G	16.500 1/min	Limiting speed
	48 g	{Weight}

Mounting dimensions

$d_{a \min}$	14,2 mm	Minimum diameter shaft shoulder
$D_{a \max}$	25,8 mm	Maximum diameter of housing shoulder
$r_{a \max}$	0,6 mm	Maximum fillet radius

Dimensions

r_{\min}	0,6 mm	Minimum chamfer dimension
D_2	25,2 mm	Caliber diameter outer ring
d_2	14,1 mm	Caliber diameter inner ring

Temperature range

T_{\min}	-20 °C	Operating temperature min.
T_{\max}	100 °C	Operating temperature max.

Calculation factors

e	0,32	Limiting value of F_a/F_r for the applicability of diff. Values of factors X and Y
Y_1	1,96	Dynamic axial load factor
Y_2	3,03	Dynamic axial load factor
Y_0	2,05	Static axial load factor