

FAG

**2201-2RS-TVH>N**

Self-aligning ball bearing

Schaeffler ID:  
0967136580000Self-aligning ball bearing 22...-2RS-TVH,  
seals, plastic cage

## Technical information

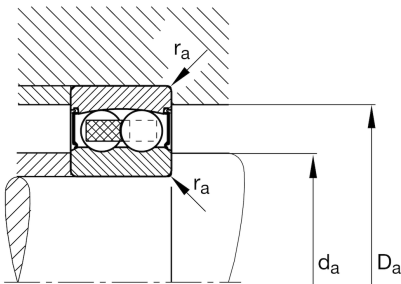
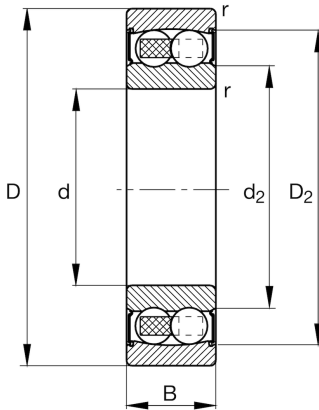
**Main Dimensions & Performance Data**

d	12 mm	Bore diameter
D	32 mm	Outside diameter
B	14 mm	Width
$C_r$	5.700 N	Basic dynamic load rating, radial
$C_{0r}$	1.270 N	Basic static load rating, radial
$C_{ur}$	80 N	Fatigue load limit, radial
$n_G$	14.700 1/min	Limiting speed
	0,053 kg	Weight

**Mounting dimensions**

$d_{a \min}$	16,2 mm	Minimum diameter shaft shoulder
$D_{a \max}$	27,8 mm	Maximum diameter of housing shoulder
$r_{a \max}$	0,6 mm	Maximum fillet radius

**Dimensions**

$r_{\min}$	0,6 mm	Minimum chamfer dimension
$D_2$	27,2 mm	Caliber diameter outer ring
$d_2$	16,2 mm	Caliber diameter inner ring

**Temperature range**

$T_{\min}$	-20 °C	Operating temperature min.
$T_{\max}$	100 °C	Operating temperature max.

**Calculation factors**

e	0,37	Limiting value of $F_a/F_r$ for the applicability of diff. Values of factors X and Y
$Y_1$	1,68	Dynamic axial load factor
$Y_2$	2,61	Dynamic axial load factor
$Y_0$	1,76	Static axial load factor