

FAG

2203-2RS-TVH>N

Self-aligning ball bearing

Schaeffler ID:
0969965440000Self-aligning ball bearing 22...-2RS-TVH,
seals, plastic cage

Technical information

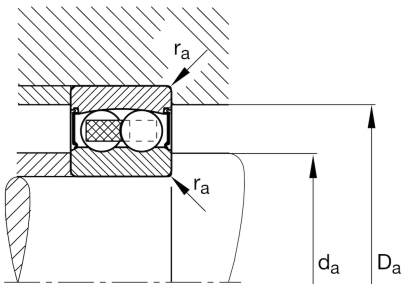
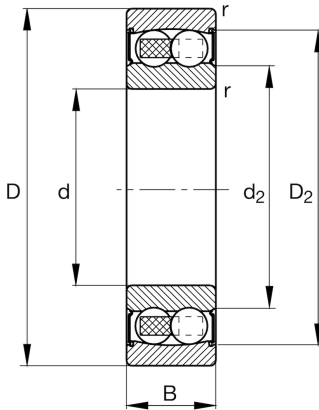
**Main Dimensions & Performance Data**

d	17 mm	Bore diameter
D	40 mm	Outside diameter
B	16 mm	Width
C_r	8.100 N	Basic dynamic load rating, radial
C_{0r}	2.010 N	Basic static load rating, radial
C_{ur}	128 N	Fatigue load limit, radial
n_G	11.300 1/min	Limiting speed
	0,095 kg	Weight

Mounting dimensions

$d_{a \min}$	21,2 mm	Minimum diameter shaft shoulder
$D_{a \max}$	35,8 mm	Maximum diameter of housing shoulder
$r_{a \max}$	0,6 mm	Maximum fillet radius

Dimensions

r_{\min}	0,6 mm	Minimum chamfer dimension
D_2	34,3 mm	Caliber diameter outer ring
d_2	21,6 mm	Caliber diameter inner ring

Temperature range

T_{\min}	-30 °C	Operating temperature min.
T_{\max}	100 °C	Operating temperature max.

Calculation factors

e	0,33	Limiting value of F_a/F_r for the applicability of diff. Values of factors X and Y
Y_1	1,93	Dynamic axial load factor
Y_2	2,98	Dynamic axial load factor
Y_0	2,02	Static axial load factor