

FAG

2205-2RS-TVH>N

Self-aligning ball bearing

 Schaeffler ID:
0969965600000

 Self-aligning ball bearing 22...-2RS-TVH,
seals, plastic cage

Technical information

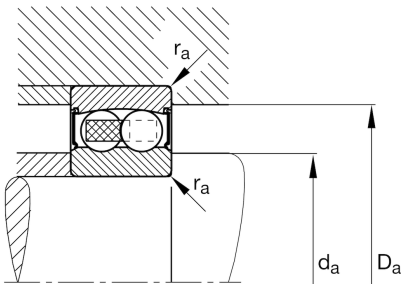
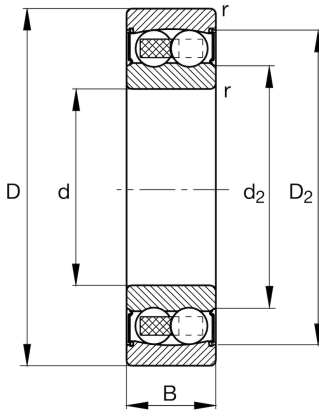

Main Dimensions & Performance Data

d	25 mm	Bore diameter
D	52 mm	Outside diameter
B	18 mm	Width
C_r	12.300 N	Basic dynamic load rating, radial
C_{0r}	3.300 N	Basic static load rating, radial
C_{ur}	209 N	Fatigue load limit, radial
n_G	8.100 1/min	Limiting speed
	155 g	{Weight}

Mounting dimensions

$d_{a \min}$	30,6 mm	Minimum diameter shaft shoulder
$D_{a \max}$	46,4 mm	Maximum diameter of housing shoulder
$r_{a \max}$	1 mm	Maximum fillet radius

Dimensions

r_{\min}	1 mm	Minimum chamfer dimension
D_2	45,3 mm	Caliber diameter outer ring
d_2	30,7 mm	Caliber diameter inner ring

Temperature range

T_{\min}	-20 °C	Operating temperature min.
T_{\max}	100 °C	Operating temperature max.

Calculation factors

e	0,27	Limiting value of F_a/F_r for the applicability of diff. Values of factors X and Y
Y_1	2,36	Dynamic axial load factor
Y_2	3,65	Dynamic axial load factor
Y_0	2,47	Static axial load factor