

# 6218/C3VL0241

## INSOCOAT® deep groove ball bearing



INSOCOAT single row deep groove ball bearings feature an electrically insulating coating on the outside surfaces of either the inner or outer bearing ring. This keeps stray electric currents from passing through the bearings, protecting them against electrical erosion damage and helping prevent lubricant degradation resulting from electric current discharge. As with deep groove ball bearings generally, they are particularly versatile, have low friction and are optimized for low noise and low vibration, which enables high rotational speeds. They accommodate radial and axial loads in both directions, are easy to mount, and require less maintenance than many other bearing types.

- Coating protects against electrical erosion damage
- Reduced lubricant degradation resulting from electric current discharge
- Typical benefits of single row deep groove ball bearings

## Overview

### Dimensions

Bore diameter	90 mm
Outside diameter	160 mm
Width	30 mm

### Performance

Basic dynamic load rating	101 kN
Basic static load rating	73.5 kN
Limiting speed	5 300 r/min
Reference speed	8 500 r/min

### Properties

Bore type	Cylindrical
Cage	Sheet metal
Coating	Insulation coating on outer ring
Filling slots	Without
Locating feature, bearing outer ring	None
Lubricant	None
Matched arrangement	No
Material, bearing	Bearing steel
Number of rows	1
Radial internal clearance	C3
Relubrication feature	Without
Sealing	Without

# Technical Specification

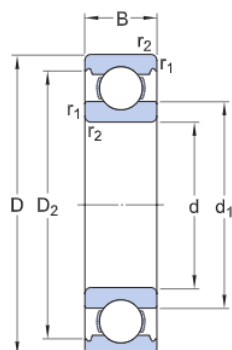

## Dimensions

d	90 mm	Bore diameter
D	160 mm	Outside diameter
B	30 mm	Width
d <sub>1</sub>	≈ 112.5 mm	Shoulder diameter inner ring
D <sub>2</sub>	≈ 145 mm	Recess diameter outer ring shoulder
r <sub>1,2</sub>	min. 2 mm	Chamfer dimension

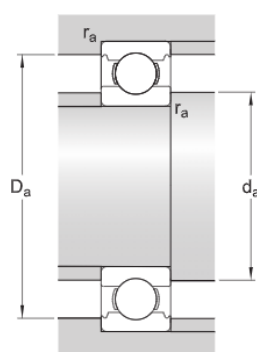

## Abutment dimensions

d <sub>a</sub>	min. 101 mm	Abutment diameter shaft
D <sub>a</sub>	min. 149 mm	Abutment diameter shaft
D <sub>a</sub>	max. 149 mm	Abutment diameter housing
r <sub>a</sub>	max. 2 mm	Fillet radius

## Calculation data

Basic dynamic load rating	C	101 kN
Basic static load rating	C <sub>0</sub>	73.5 kN
Fatigue load limit	P <sub>u</sub>	2.8 kN
Reference speed		8 500 r/min
Limiting speed		5 300 r/min
Calculation factor	k <sub>r</sub>	0.025
Calculation factor	f <sub>0</sub>	14.7

## Mass

Mass bearing	2.4 kg
--------------	--------

# Terms and conditions

By accessing and using this website / app owned and published by AB SKF (publ.) (556007-3495 · Gothenburg) ("SKF"), you agree to the following terms and conditions:

## Warranty Disclaimer and Limitation of Liability

Although every care has been taken to assure the accuracy of the information on this website / app, SKF provides this information "AS IS" and DISCLAIMS ALL WARRANTIES, EXPRESS OR IMPLIED, INCLUDING, BUT NOT LIMITED TO, IMPLIED WARRANTIES OF MERCHANTABILITY AND FITNESS FOR A PARTICULAR PURPOSE. You acknowledge that your use of this website / app is at your sole risk, that you assume full responsibility for all costs associated with use of this website / app, and that SKF shall not be liable for any direct, incidental, consequential, or indirect damages of any kind arising out of your access to, or use of the information or software made available on this website / app. Any warranties and representations in this website / app for SKF products or services that you purchase or use will be subject to the agreed upon terms and conditions in the contract for such product or service. Further, for non-SKF websites / apps that are referenced in our website / app or where a hyperlink appears, SKF makes no warranties concerning the accuracy or reliability of the information in these websites / apps and assumes no responsibility for material created or published by third parties contained therein. In addition, SKF does not warrant that this website / app or these other linked websites / apps are free from viruses or other harmful elements.

## Copyright

Copyright in this website / app copyright of the information and software made available on this website / app rest with SKF or its licensors. All rights are reserved. All licensed material will reference the licensor that has granted SKF the right to use the material. The information and software made available on this website / app may not be reproduced, duplicated, copied, transferred, distributed, stored, modified, downloaded or otherwise exploited for any commercial use without the prior written approval of SKF. However, it may be reproduced, stored and downloaded for use by individuals without prior written approval of SKF. Under no circumstances may this information or software be supplied to third parties.

This website /app includes certain images used under license from Shutterstock, Inc.

## Trademarks and Patents

All trademarks, brand names, and corporate logos displayed on the website / app are the property of SKF or its licensors, and may not be used in any way without prior written approval by SKF. All licensed trademarks published on this website / app reference the licensor that has granted SKF the right to use the trademark. Access to this website / app does not grant to the user any license under any patents owned by or licensed to SKF.

## Changes

SKF reserves the right to make changes or additions to this website / app at any time.